

## T70-A: PHOTOVOLTAIC TRACKING DIGITAL OUTPUT DUAL-AXIS TILT SENSOR

### ■ PRODUCT DESCRIPTION



The T70-A is a dual-axis digital inclination sensor developed by MXMW Hi-Tech Company for its component MEMS inclination measurement module. It adopts RTU Modbus protocol and its internal core components are 100% produced in China, including MCU processor, A/D converter, and power circuit, output circuit, etc. For domestic equipment manufacturing, overcome technical barriers to independent research and development. All products have been calibrated, temperature compensated, and long-term aging and stability tested before leaving the factory. Each process is precise and rigorous to ensure reliability under different working conditions and long-term use cycles.

### ■ PRODUCT MAIN SPECIFICATION

Parameter	Conditions	T70-A		Unit
Measuring range		±90	±180	°
Measuring axis	Y axis (optional)	X, Y	X	
Accuracy	-30 ~ 70°C	0.2	0.3	°
Long term stability	-30 ~ 70°C	<0.22	<0.35	Hz
Sensitivity temperature coefficient	-30 ~ 70°C	≤200		ppm/°C
Frequency response	DC response	100		Hz
Power-on start time		0.2		s
Response time		0.01		s
Automatic output rate	5Hz output, 15Hz, 35Hz, 50Hz can be set (RS485 does not have this function)			
Output signal	RS232/RS485/RS422/TTL /MODBUS can be ordered			
Average working hours	≥35000 hours/time			
Impact resistance	2450g, 0.5ms, 3 times/axis			
Anti-vibration	10grms、10 ~ 1000Hz			
Insulation resistance	≥100MΩ			
Waterproof level	IP67			
Cable wire	Standard 1.5m length, wear-resistant, oil-proof, wide temperature, shielded cable 4*0.2mm <sup>2</sup>			
Weight	30g (excluding packaging box)			

### ■ PRODUCT DIMENSION

SIZE: L81\*W40\*H40MM

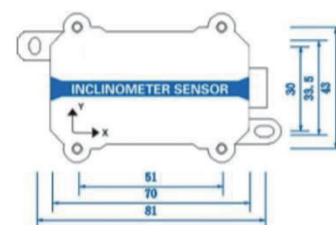
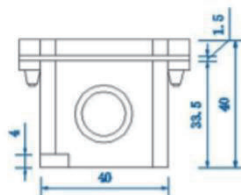
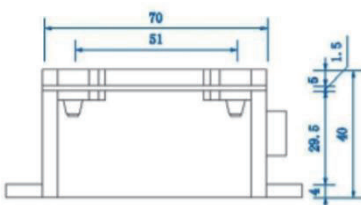

### ■ PRODUCT APPLICATION

- High-voltage power line tower monitoring
- Aerial work vehicles
- Pan/tilt leveling
- Photovoltaic tracking
- Mining machinery, oil drilling equipment
- Medical equipment
- Angle control of various construction machinery
- Vehicle overload monitoring