

AC-6: HIGH PRECISION QUARTZ ACCELEROMETER

■ PRODUCT DESCRIPTION



AC-6 quartz flexible accelerometer series is a small, high temperature resistant seismic type accelerometer. The product has excellent repeatability, starting performance, high temperature seismic resistance and high reliability characteristics, which can be used for both static testing and dynamic testing, and is also a standard vibration sensor. The product adopts unique miniaturization, high temperature resistant seismic design, advanced packaging process and special circuit, the output current of the product is proportional to the input acceleration, the user can select the appropriate sampling resistance through calculation, to achieve high precision output. And according to the user requirements of the built-in temperature sensor, can be used to compensate for the partial value and scale factor, to reduce the impact of environmental temperature. Since the launch of this product was launched in 2012, the number of deliveries has reached thousands. After years of application, it has become a mature product.

■ PRODUCT MAIN SPECIFICATION

Parameters	AC-6A	AC-6B	Unit
Range	±30	±30	G
Threshold /Resolution	30	30	μg
Bias k0/k1	≤±20	≤±20	mg
Scale factor k1	1.9~2.1	1.9~2.1	mA/g
Class II nonlinearity coefficient k2/k1	≤±20	≤±50	μg /g ²
Bias drift Sigma k0 (1σ, one month)	≤150	≤220	μg
Stability of scale factor Sigma k1/k1 (1σ, one month)	≤150	≤220	ppm
Class II nonlinearity Coefficient stability k2/k1 (1σ, one month)	≤±40	≤±50	μg /g ²
Bias thermal coefficient	≤±80	≤±150	μg /°C
Scale factor thermal coefficient	≤100	≤200	ppm /°C
Noise (sample resistance 840Ω)	≤8	≤8.4	mv
Natural frequency	350~800	350~800	Hz
Bandwidth	800~2500	800~2500	Hz
Vibration (@20~2000Hz)	25	25	G
Shock	1000g	1000g	0.5ms, 1/2sin
Temperature range (Operating)	-40~+150	-40~+150	°C
Temperature range (Saved)	-60~+180	-60~+180	°C
Power	±12~±15	±12~±15	V
Consume current	±20	±20	mA
Size	Φ18.2X16	Φ18.2X16	Mm
Weight	25	25	G

■ PRODUCT DIMENSION

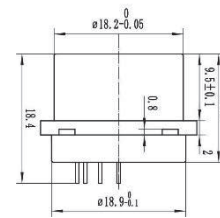
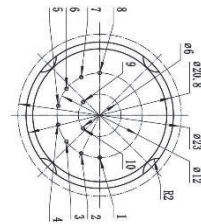

Outline for AC-6A (Round)

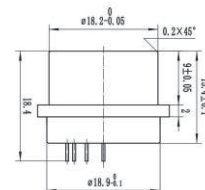
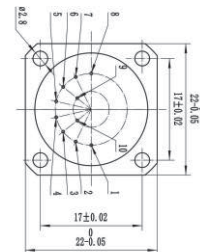

Outline for AC-6B (Square)

■ PRODUCT APPLICATION

- oil and gas drilling, earth exploration